

ExoAir 230 at 50 wet mils with reinforcing mesh

(Recommended, but not required)

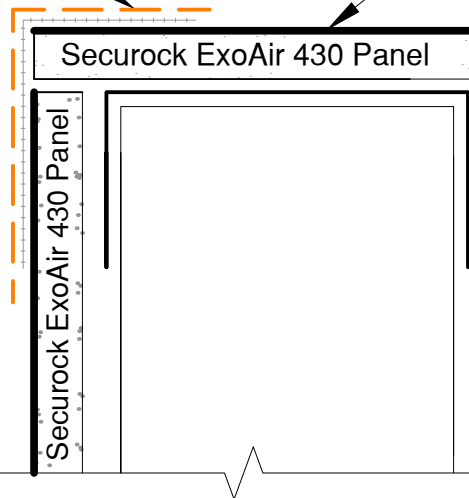

NOTES:

- Apply ExoAir Primer to all exposed gypsum core prior to application of membrane
- Slope to the exterior 1/8" per 12"
- Install reinforcing mesh with 50 wet mils of ExoAir 230, completely covering reinforcing mesh
- Flashing must be installed past thermal break

See securockexoair.com for the most up-to-date product information

This detail is intended for conceptual purposes only. Must be reviewed by a project/design professional

The following trademarks used herein are owned by USG Corporation or its subsidiaries: SECUROCK, USG, USG in stylized letters. The following trademarks used herein are owned by Tremco Incorporated or its subsidiaries: Tremco, ExoAir, Spectrem, Dymonic, Proglaze, Vulkem.



United States Gypsum Company
 550 West Adams Street
 Chicago, IL 60661
 USG Technical & Customer Support:
 800.USG.4YOU (874-4968)

Tremco Commercial Sealants & Waterproofing
 3735 Green Road
 Beachwood, OH 44122
 Tremco Technical Support:
 866.209.2404

SECUROCK® ExoAir® 430 Panel
 Project:
 Detail: Rough Opening - Fluid-Applied Flashing - Panel
 Drawn by: **KAB** Approved by: **DM** Scale: NTS

File Name:
12787
 Date: 3/20/2017

Rev #
00